



HANDLE, LATCH, DEADBOLT & CLOSER INSTALLATION
INSTRUCTIONS FOR OUT SWINGING DOOR
DELUXE 3-SEASON, STANDARD 3-SEASON
DURA-BREEZE, DELUXE AND FULL SCREEN ROOMS



Step 1

Insert Spindle Cup into the Button with the Spindle Cup opening facing out, then Assemble outside handle with button (arrow facing up), Spindle, and Spring. Guide this assembly through installation holes from outside of door. See Figure 1.

Step 2

Push button to extend spindle. Position inside latch over holes, guiding spindle into rectangular slot in center of latch. Insert both self tapping machine screws through the holes in the inside latch and turn each down to a snug position. **Do not tighten.** Check to make sure that the spindle works freely by pushing button.

Step 3

From inside of door, install self tapping machine screw in lower handle hole and tighten. Tighten top latch screws.

Step 4

Position Strike on door jam to match latch then mark and drill two 1/8" holes and fasten with two #8 x 3/8" pan head sheetmetal screws. See Figure 2.

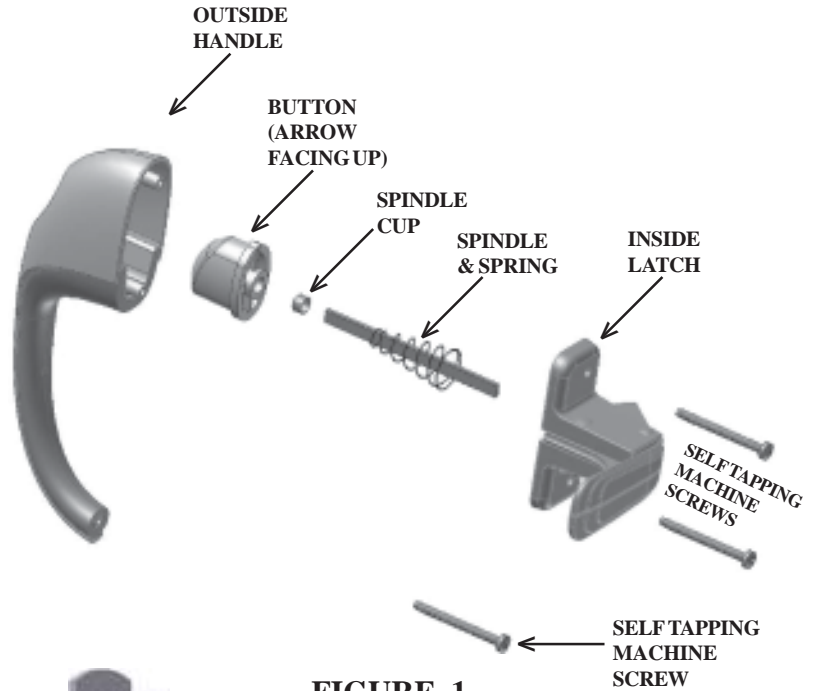
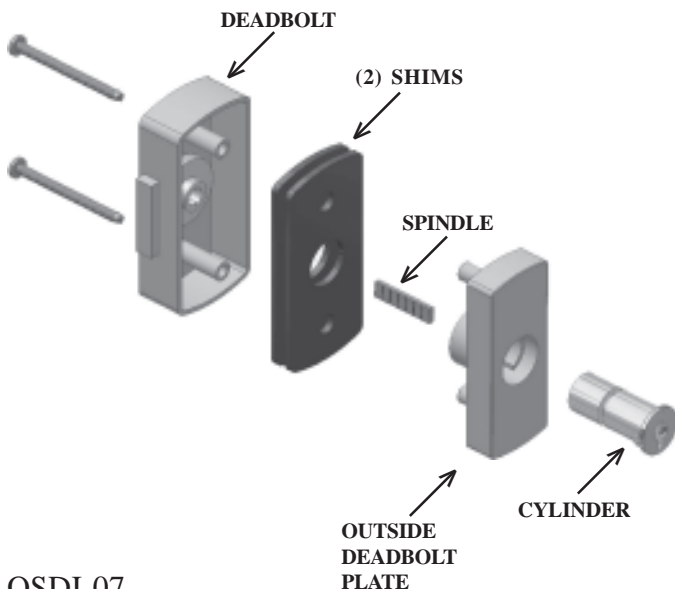

FIGURE 1



FIGURE 2



Step 1

Assemble key and cylinder to outside deadbolt plate by inserting the key and cylinder into the outside deadbolt plate and turning the key one half turn. Remove key from cylinder prior to further installation.

Step 2

Cut spindle to 7/8" long and assemble spindle to outside deadbolt assembly.

Step 3

Insert outside deadbolt assembly (with spindle) from outside of door.

Step 4

Install dead bolt and 2 deadbolt shims on inside of door with bolt facing jamb; install and tighten screws.

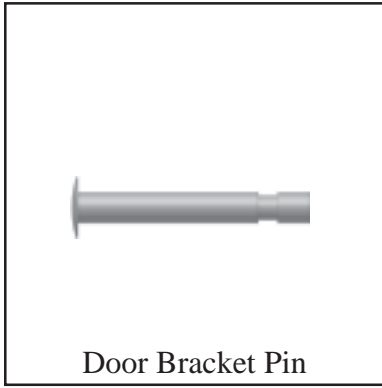
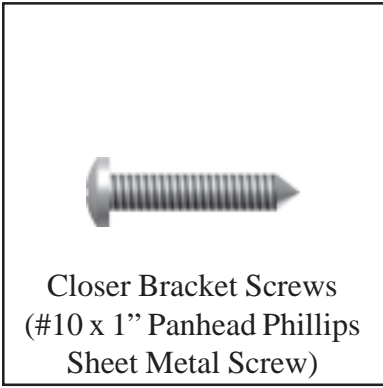
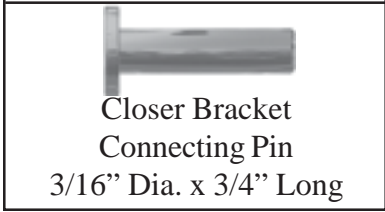
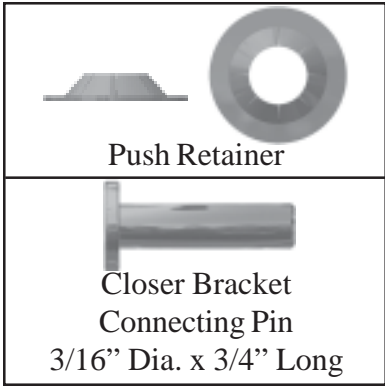
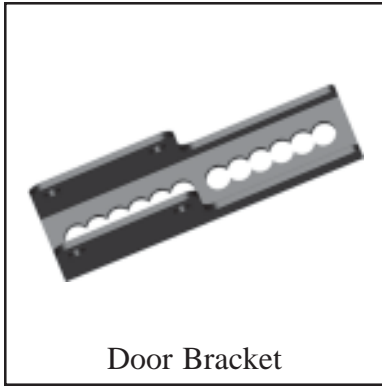
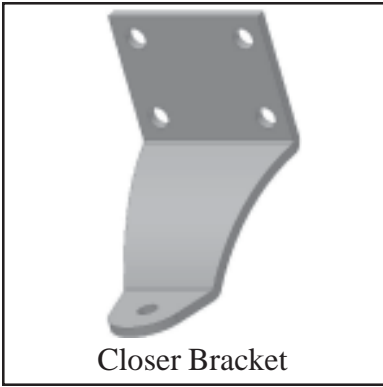

Instructions

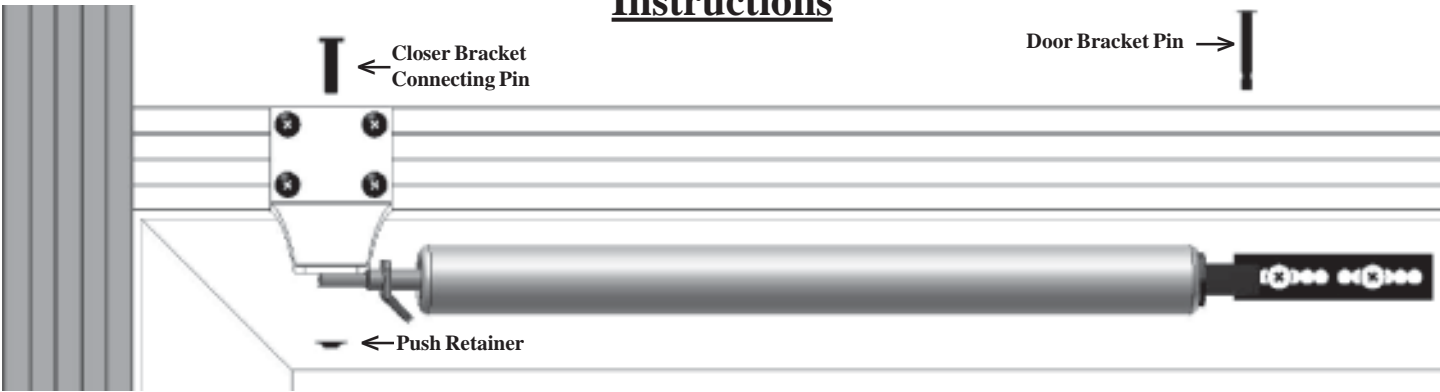

1. Locate and pre-drill the four (4) factory marked Positions with a 9/64" drill. Attach the Closers Bracket to the Door Header oriented as shown with four (4) Closers Bracket Screws.
2. Slide the Hold Open Washer on to the Shaft of the Door Closer as shown.
3. With the Hold Open Washer on the Shaft slide the Closers Bracket Connecting Pin through the Closers Bracket and through the shaft of the Door Closer, then using a pair of pliers squeeze the Push Retainer on to the Pin.
4. With the Door Closer attached to the Closers Bracket, insert the Door Closer into the Door Bracket and attach it with the Door Bracket Pin.

NOTE: The Closer is in **Maximum** latching power position with (pin in Hole 1). If less power is required, hold door open with Hold Open Washer, pull Door Connecting pin and relocate in Hole 2.